

尊敬的用户：

感谢您选购得胜EBS-640定阻吸顶音箱，为了您能够更好的了解使用本产品，建议您在使用前仔细阅读本说明书。

若存在有疑问或者您有宝贵的建议，可通过拨打得胜官方服务热线 400 6828 333 或微信扫描二维码关注得胜官方公众号与我们联系。



## ■ 产品特性

- 单元结构上由一个6.5寸25芯纸盆低音和一个25芯丝膜球顶高音组成。低音采用弹性与耐疲劳性俱佳的橡胶折环，低频反应迅速、动态足；纸盆表面特殊处理，使音乐表现层次清晰；磁路采用对称设计，谐波失真小。高音采用透明丝膜，高频透亮平滑、细腻；采用钕铁硼磁路，质量轻，高频纤细，细节表现力好；磁路间隙中填充磁液，能有效降低音圈温度，提升高音可靠性；配上特定指向性号角，能有效控制辐射范围，能量更集中。高音与低音同轴设计，声中心一致，声像定位准确。
- 分频器的元件采用了损耗值较低的无氧铜电感、高品质聚丙烯电容，以及散热性能良好的水泥电阻，使分频网络稳定，音质出众。
- 箱体后腔采用圆桶结构，内壁贴附吸音棉能减少驻波的产生，使低频在听感上表现得更干净，频响上更平坦；整个塑胶箱体主要由上下盖两大部分组成，结构紧凑，气密性良好，使扬声器系统的声泄漏较少，能量更足。

## ■ 包装清单

EBS-640 音箱 ..... 2个  
铁网 ..... 2个  
说明书 ..... 1份

## ■ 适用范围

会议室、多功能厅、大型商场

## ■ 技术参数

额定功率：80W(AES)	悬挂/安装：卡扣固定
额定阻抗：16Ω	开孔尺寸：233±2mm
频率响应（±3dB）：70Hz-20kHz	接线方式：按压式接线端子
灵敏度（1W/1M）：90dB	(IN: 红+, 黑-)
覆盖角：H90°×V90°	箱壳：ABS
最大声压级：106dB	表面处理：白色
分频模式：无源二分频	高频：1"×1 (25芯)，丝膜球顶
分频点：2800Hz	低频：6.5"×1 (25芯)，90磁钢
	规格 (mm)：φ260×H197

注：以上数据由得胜实验室测试得到，并拥有最终解释权！

## ■ 安装方式

- 1.在天花板上开一个直径233mm的安装圆孔；
- 2.连接信号线至音箱底部红黑接线端子；
- 3.将音箱主体部分由安装圆孔嵌入天花板，把卡扣旋转90°扣住天花板，然后拧紧螺丝；（如图1）
- 4.扣上铁网。（如图2）

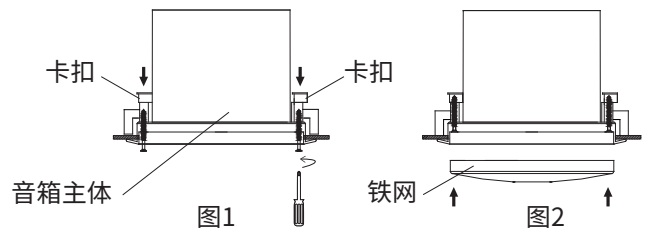

## ■ 注意事项

- 1.此吸顶音箱阻抗为16Ω，建议2只-4只并联使用。
- 2.确保功率放大器和音箱的功率、阻抗相匹配，失衡搭配可导致设备损坏或音质效果不佳。
- 3.请根据房间大小排布音箱（单只音箱覆盖面积约15m<sup>2</sup>，注：参考会议室天花板高度3.5m），以确保获得较佳听感。
- 4.搬运音箱时，请小心轻放，保护好音箱不受损坏，禁止用手抓高音号角来移动音箱。

## ■ 安全警示

为避免电击、高温、着火、辐射、爆炸、机械危险以及使用不当等可能造成的人身伤害或财产损失，使用本产品前，请仔细阅读并遵守以下事项：

- 1.使用产品时请确认所连接设备与本产品功率是否匹配以及合理调整音量大小，不要在超过产品功率及大音量下长时间使用，以免造成产品异常和耳朵听力损伤；
- 2.使用中若发现有异常（如冒烟、异味等），请立即关闭电源开关并拔掉电源插头，然后将产品送经销商检修；
- 3.本产品及配件都应放置在室内干燥通风处，勿长期存放在潮湿、灰尘多的环境，使用中避免靠近火源、碰到液体物质、雨淋、过度碰撞、抛掷、振动本机及覆盖通风孔，以免损坏其功能；
- 4.若产品需要固定于墙壁或天花板上时，请确保固定到位，防止因固定强度不足导致产品发生跌落危险；
- 5.使用该产品时需遵守相关安全规定，法律法规明确禁止使用场合请勿使用本机，以免导致意外事故；
- 6.请不要自行拆机改装或维修，以防止出现人身伤害，如有问题或服务需求请联系当地经销商跟进处理；

产品服务保证书		
姓名：_____ 电话：_____ 地址：_____		
商品：_____ 型号：_____ 购买日期：_____年__月__日		
维修记录栏(由维修员填写)	维修员签名	日期

◆广东得胜电子有限公司 ◆电话：400-6828-333 ◆地址：广东省惠州市博罗县龙溪街道富康一路2号

※本产品相关规格如有变更恕不另行通知。

9TBS640S1C



Dear Customer,

Thank you for purchasing Takstar EBS-640 fixed impedance ceiling speaker which features vented two way. Please read the user manual carefully before operation and keep it for reference in future. If you have any question or suggestion, please contact our local dealer.

## ■ Features

EBS-640 consists of one 6.5 inch 25mm cone woofer and one 25mm silk dome tweeter. The woofer is designed with elastic and durable rubber surround for quick response and sufficient dynamic, specially processed cone for clear music performance, symmetric magnet for low harmonic distortion. The tweeter is designed with silk dome for flat treble, NdFeB magnet for light weight and slender HF. The magnet is filled with magnetic liquid to reduce the voice coil temperature and promote the performance reliability. With the specific directivity horn together, it effectively controls the projection range, and concentrates the energy. The coaxial design offers accurate pan.

## ■ Product content

EBS-640 ceiling speaker .....2pc  
 Grille .....2pc  
 User manual .....1pc

## ■ Application

Conference room, multi-function hall, large shop

## ■ Specification

Rated Power: 80W(AES)  
 Rated Impedance: 16Ω  
 Frequency Response (±3dB): 70Hz-20KHz  
 Sensitivity (1W/1M): 90dB  
 Coverage: H90°×V90°  
 Max SPL: 106dB  
 Crossover Mode: two way passive  
 Crossover Frequency: 2800Hz  
 Installation: latch to fix the position  
 Hole Size: 233±2mm  
 Wiring: binding posts (IN: red+, black-)  
 Enclosure: ABS  
 Finish: white  
 HF: 1"×1 (25mm), silk dome  
 LF: 6.5"×1 (25mm), 90 magnet  
 Dimension(mm): φ260 ×H197

Note: the above data is obtained from the test of Takstar laboratory, and has the final interpretation right!

## ■ Installation

1. Open a 233mm diameter hole on the ceiling.
2. Connect the signal cable with red and black binding posts of the ceiling speaker.
3. Insert the ceiling speaker into the ceiling. Turn the bolts 90° to fix the speaker position on ceiling. Tighten the screws (refer to figure 1).

4. Assemble the metal grille (refer to figure 2).

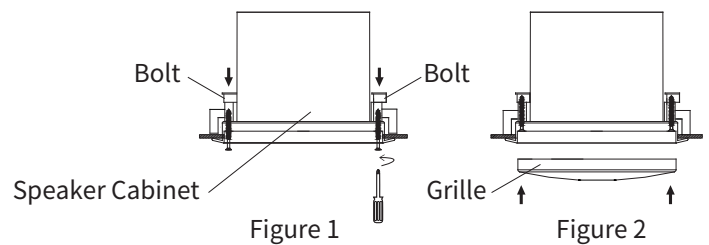

## ■ Cautions

1. The impedance of this ceiling speaker is 16Ω. It is recommended to parallel 2 to 4 speakers in application.
2. Please ensure the impedance and power of ceiling speaker match with that of power amplifier. If not, it leads to equipment damage or bad sound.
3. Please install the ceiling speaker according to the room space (one speaker for 15m<sup>2</sup>, note: the reference ceiling height is 3.5m) to ensure good sound effect.
4. When moving the ceiling speaker, please handle with care for protection. It is forbidden to hold the horn to move the ceiling speaker.

## ■ Safety instruction

- To avoid electric shock, over temperature, catching fire, explosion, mechanical risk and hurt or property loss caused by improper use, please read the following items carefully before operation:
1. Make sure the power of connected equipment matches with that of this product. Adjust the volume to proper level during operation. Do not operate at high volume level to avoid hearing loss.
  2. If abnormal phenomenon (smoke, abnormal smell) happens, please turn off the power switch and disconnect the power plug with power socket, and send the product to local dealer for maintenance.
  3. The product and accessories should be put in dry and ventilated place rather than humid or dusty environment. Prevent the product from liquid, rain, water, over-colliding, throwing, vibrating, vent hole covered to avoid function destroyed.
  4. When the product needs to be installed on wall or ceiling, please fix it tightly to avoid dropping risk.
  5. Please abide by safety rules during operation. Do not use the product in the place prohibited by regulation or law to avoid accident.
  6. Do not disassemble or repair the product by yourself to avoid hurt. If you have question or need service, please contact the local dealer.

※The product specification is subject to change without prior notice.